

# Hall of Knowledge

## Ground Floor

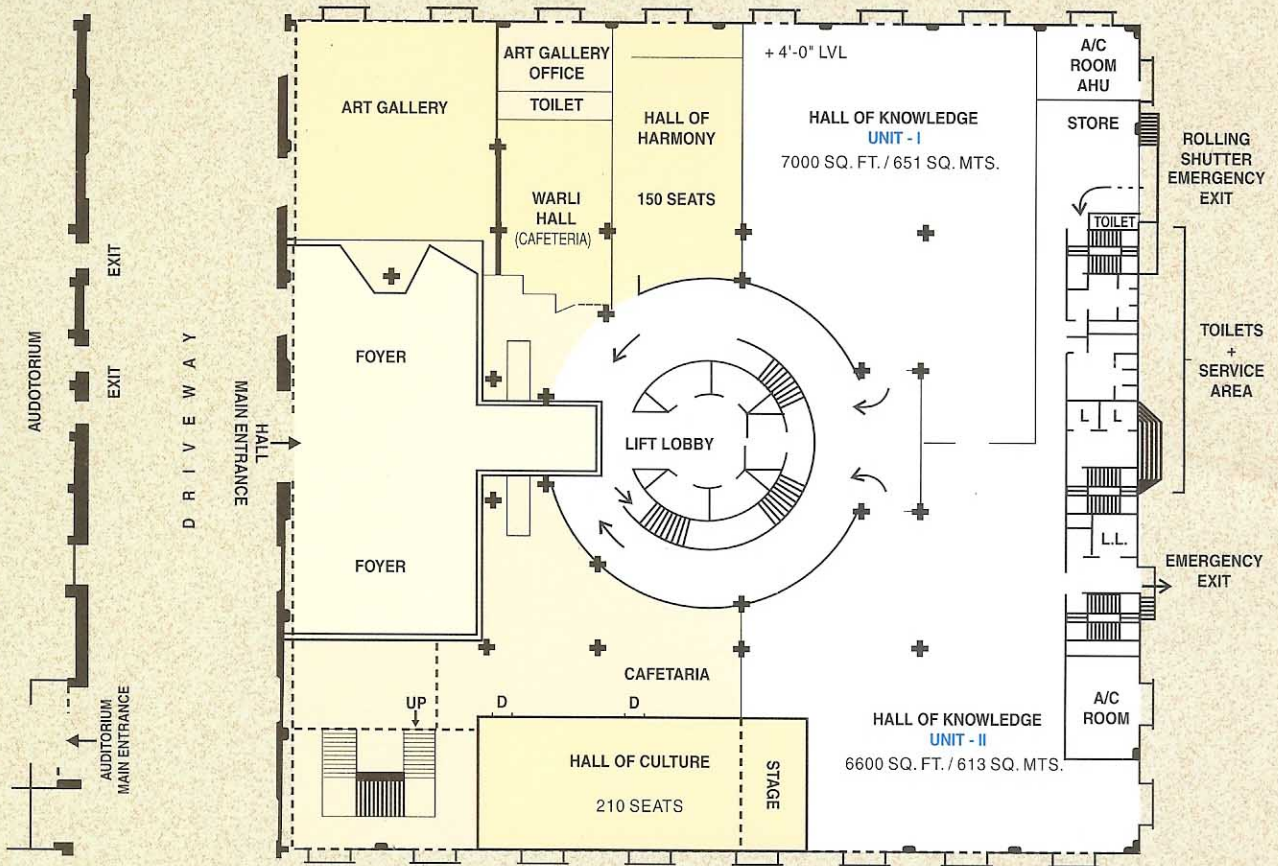

## Salient features of Hall of Knowledge

	Unit - I	Unit - II
<b>AREA</b> (Gr. Floor)	7000.00 Sq. Ft. (651.00 Sq. Mt.)	6600.00 Sq. Ft. (613.00 Sq. Mt.)
<b>CEILING</b>	High ceiling Bottom of Tubes 18'-0" (18 Feet)	High ceiling Bottom of Tubes 18'-0" (18 Feet)
<b>GENERAL LIGHTING</b>	Square 4'-0" Tube lights fitting.	
<b>AIR CIRCULATION</b>	Central air conditioned hall.	
<b>ELECTRICITY</b>	Distribution panels all along walls of halls (Single & Three phase power available with prior intimation along with requirements).	
<b>TOILETS</b>	Gents and ladies common for all units & worker's toilets separate.	
<b>DRINKING WATER</b>	Cooler with ultraviolet purifier.	
<b>PACKING &amp; UNPACKING AREA</b>	Behind Unit-I small area @ 750.00 Sq. Ft. (@ 70.00 Sq. Mt.).	
<b>FLOOR LOAD</b>	Light / Medium-Heavy Machines possible with uniform distribution of load in consultation with engineer-in-charge.	