

# Hall of Progress Ground Floor (REAR SIDE OF THE AUDITORIUM)

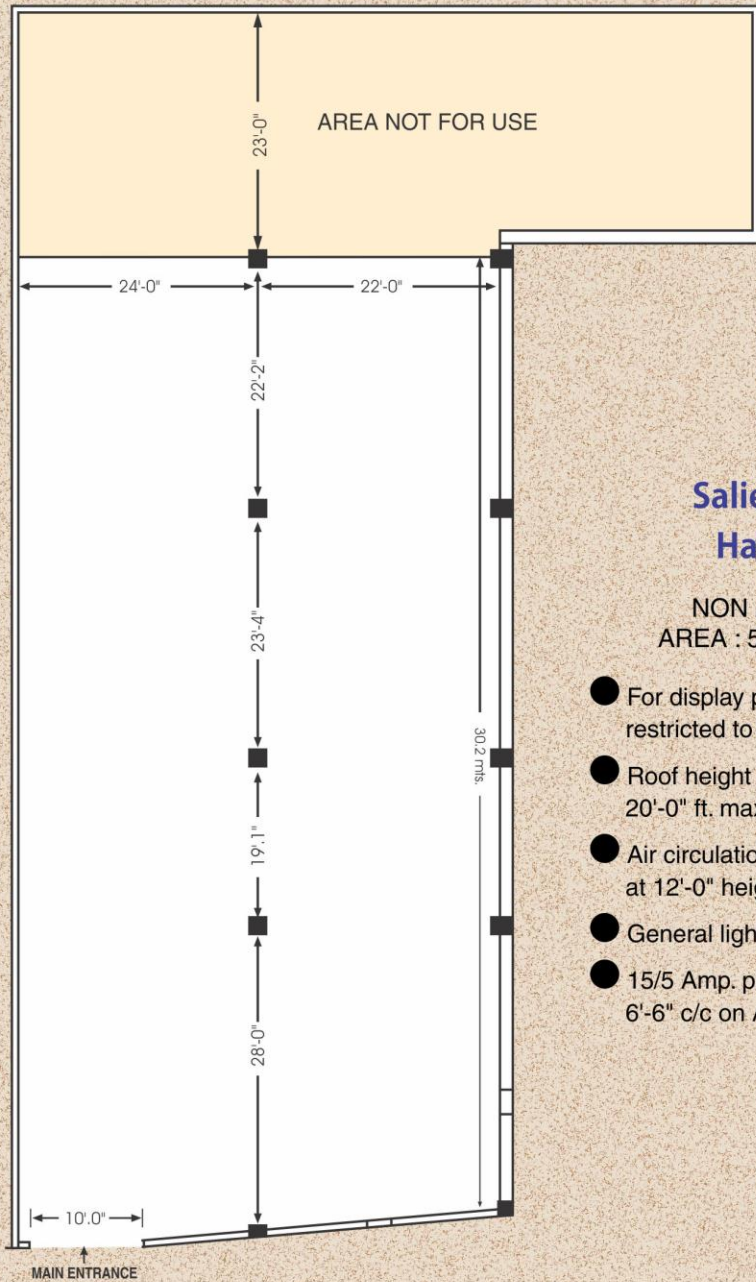

## Salient Features of Hall of Progress

NON AIR-CONDITIONED  
AREA : 5000 Sq. Ft. (APPROX.)

- For display purpose height will be restricted to 12'-0" (3.66 mt.).
- Roof height is very high minimum 20'-0" ft. maximum @ 36'-0".
- Air circulation with ceiling fans (49 Nos.) at 12'-0" height.
- General lighting with Tubes 4'-0" (48 Nos.)
- 15/5 Amp. plug points available @ 23 Nos. 6'-6" c/c on Auditorium wall & 16 Nos.